

Group in catalogue: UV-C LUMINAIRES

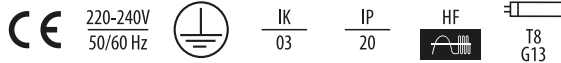
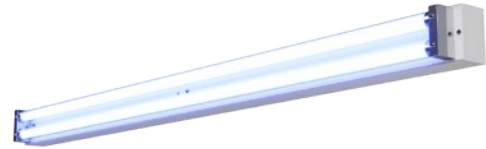

Specialized bactericidal and virucidal luminaire with T8 light sources. Surface mounted luminaire, emitting UV-C radiation with a wavelength of 253.7 nm.

TECHNICAL DATA**Mounting:** surface mounted**Body:** powder-painted steel sheet**Colour:** white**ELECTRICAL DATA****Power:** 220-240V 50/60Hz**Includes light source:** yes**Type of equipment:** PIR motion detector, remote control**Electrical connection:** max 3x1,5 mm² wire**OPTICAL DATA****Light distribution:** symmetric**Way of lighting:** direct**GENERAL DATA****Operating temperature range:** 0°C ... +35°C**Additional information:** *maximum decontamination area for 90%; up to 99% - the exposure time should be extended 2 times; at 99.9% - the exposure time should be extended 3 times**Other remarks:** Recommended mounting height of the luminaire from 2.1 m to 2.5 m. Ozone Free.**Warranty:** 2 years**Application:** hospitals, laboratories, clinics, pharmacy, pharmaceutical and cosmetics industry, hotels, schools, kindergartens, nurseries, service companies, production facilities, means of transport

Code	Type of equipment	Number of UV-C lamps	Type of radiant tube [W]	Luminaire power [W]	Max. decontamination area [m ²]*	Decontamination time [hh: mm]	UV-C radiant tube lifetime [h]
Type: with light source operating time counter							
170011.1021.201	-	1	30	33	12	03:10	9000
170011.1031.201	-	1	36	40	15	02:43	9000
170011.1051.201	-	2	30	66	18	03:02	9000
170011.1061.201	-	2	36	79	22	02:33	9000
170011.1021.201.920	PIR motion detector	1	30	35	12	03:10	9000
170011.1031.201.920	PIR motion detector	1	36	41	15	02:43	9000
170011.1051.201.920	PIR motion detector	2	30	68	18	03:02	9000
170011.1061.201.920	PIR motion detector	2	36	81	22	02:33	9000
Type: with light source operating time counter and remote control							
170011.1021.203	remote control	1	30	35	12	03:10	9000
170011.1031.203	remote control	1	36	41	15	02:43	9000
170011.1051.203	remote control	2	30	68	18	03:02	9000
170011.1061.203	remote control	2	36	81	22	02:33	9000
Type: STANDARD							
170011.1021.200	-	1	30	33	12	03:10	9000
170011.1031.200	-	1	36	40	15	02:43	9000
170011.1051.200	-	2	30	66	18	03:02	9000
170011.1061.200	-	2	36	79	22	02:33	9000

WARNING: UV emitted from this product. Avoid eye and skin exposure to unshielded product.

Power tolerance +/- 10%.

Lighting beam, light intensity distribution and light efficiency were examined in accordance with the EN ISO 17025:2005 norm for EN13032 norm series and the LM-79 norm.

Up-to-date product info and General Warranty Terms available on our website www.luglightfactory.com

Detailed information on luminous fluxes and powers for individual indexes are indicated on the product data sheet.

The parameters in the data sheet are given for Ta=25°C.



Code	Dimensions [mm] L W H	Mounting dimensions [mm] L	Pallet quantity	Quantity in package	Net weight [kg]
Type: with light source operating time counter					
170011.1021.201	940 50 88	690	130	1	1.7
170011.1031.201	1250 50 88	1000	130	1	2.1
170011.1051.201	940 50 88	690	130	1	1.7
170011.1061.201	1250 50 88	1000	130	1	2.4
170011.1021.201.920	940 50 88	690	130	1	1.7
170011.1031.201.920	1250 50 88	1000	130	1	2.1
170011.1051.201.920	940 50 88	690	130	1	1.8
170011.1061.201.920	1250 50 88	1000	130	1	2.3
Type: with light source operating time counter and remote control					
170011.1021.203	940 50 88	690	130	1	1.7
170011.1031.203	1250 50 88	1000	130	1	2.1
170011.1051.203	940 50 88	690	130	1	1.7
170011.1061.203	1250 50 88	1000	130	1	2.4
Type: STANDARD					
170011.1021.200	940 50 88	690	130	1	1.6
170011.1031.200	1250 50 88	1000	130	1	2.0
170011.1051.200	940 50 88	690	130	1	1.6
170011.1061.200	1250 50 88	1000	130	1	2.3

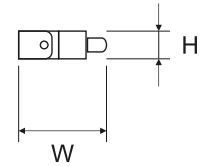
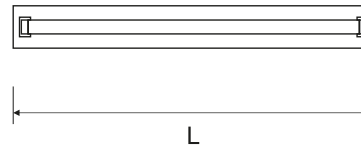

OTHER PICTURES



ACCESSORIES



150251.01075 Adjustable mounting bracket white

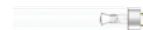

- UV-C 254nm T8 G13 30W lamp



150251.01084 Mobile stand white 1790x610



- UV-C 254nm T8 G13 36W lamp

150251.01085 Protective grille 1x900 white

150251.01086 Protective grille 1x1200 white

150251.01098 Protective grille 2x900 white

150251.01099 Protective grille 2x1200 white



150251.01091 Mounting bracket for mobilestand

WARNING: UV emitted from this product. Avoid eye and skin exposure to unshielded product.

Power tolerance +/- 10%.

Lighting beam, light intensity distribution and light efficiency were examined in accordance with the EN ISO 17025:2005 norm for EN13032 norm series and the LM-79 norm.

Up-to-date product info and General Warranty Terms available on our website www.luglightfactory.com

Detailed information on luminous fluxes and powers for individual indexes are indicated on the product data sheet.

The parameters in the data sheet are given for Ta=25°C.



LIGHT BEAM CURVES

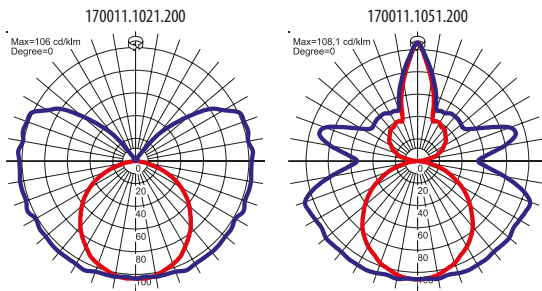

WAY OF LIGHTING

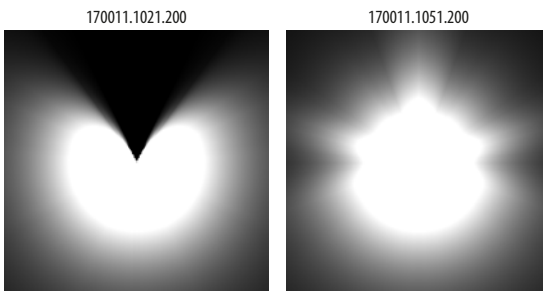

WARNING: UV emitted from this product. Avoid eye and skin exposure to unshielded product.

Power tolerance +/- 10%.

Lighting beam, light intensity distribution and light efficiency were examined in accordance with the EN ISO 17025:2005 norm for EN13032 norm series and the LM-79 norm.

Up-to-date product info and General Warranty Terms available on our website www.luglightfactory.com

Detailed information on luminous fluxes and powers for individual indexes are indicated on the product data sheet.

The parameters in the data sheet are given for $T_a=25^{\circ}\text{C}$.

